

Fisher Enterprises Assembly Instructions—Contempo Speaker Stand 901

Adjustable table

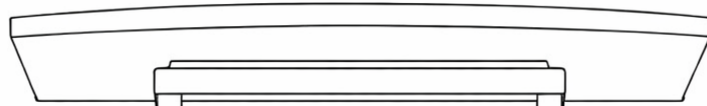

Inner column

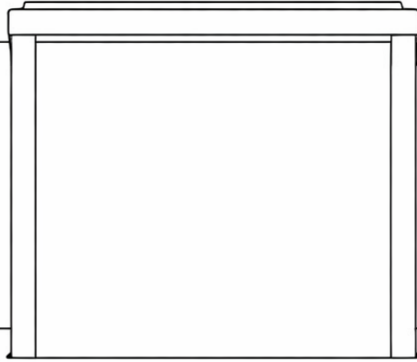

Shelf

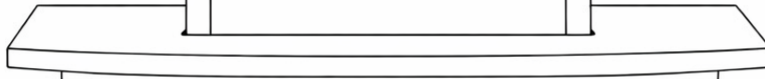

Outer column

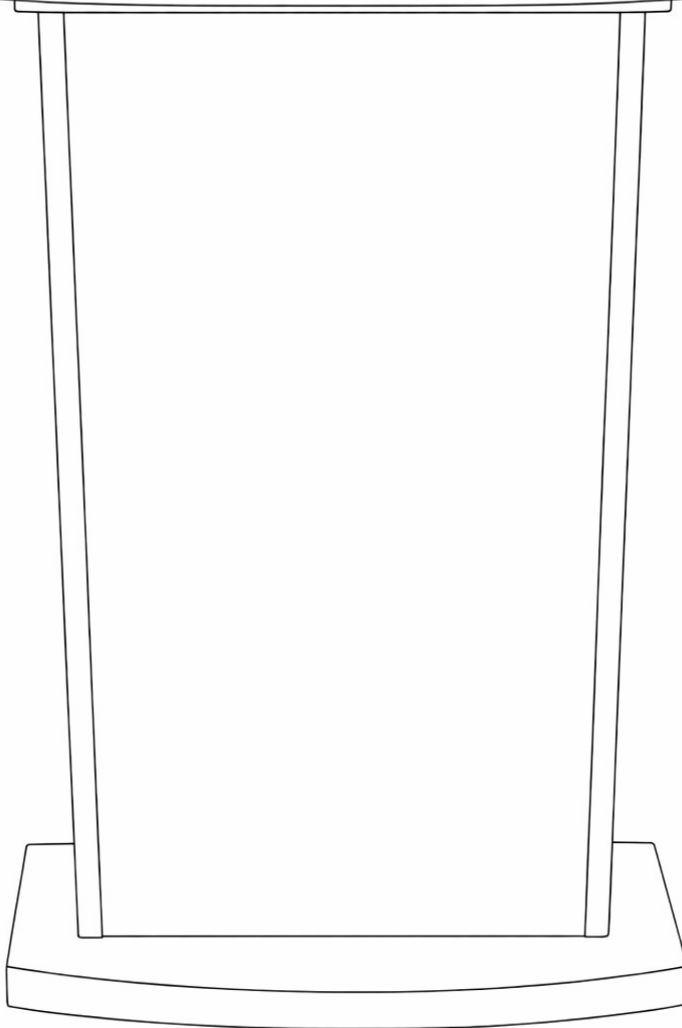

Foot

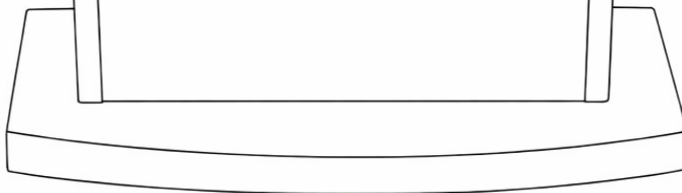

Step 1: Attach Foot

Remove all contents from the box .. Gas spring is located in one of the filler boxes.

Attach the foot to the outer column with the eight 2 1/2 inch Philips screws.



Step 2: Attach Shelf Bracket

Stand the base column up and attach the shelf bracket to the outer column using 2" screws. Please follow marks indicating front or back of the bracket

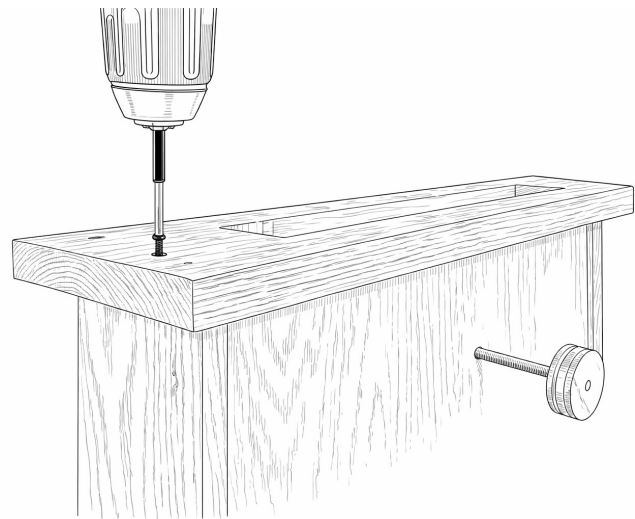

Step 3: Attach Shelf

Attach the mid shelf to the base column using six 1 1/4" Philips screws. With shelf laying on a flat surface, flip lectern and attach to bored holes in shelf.

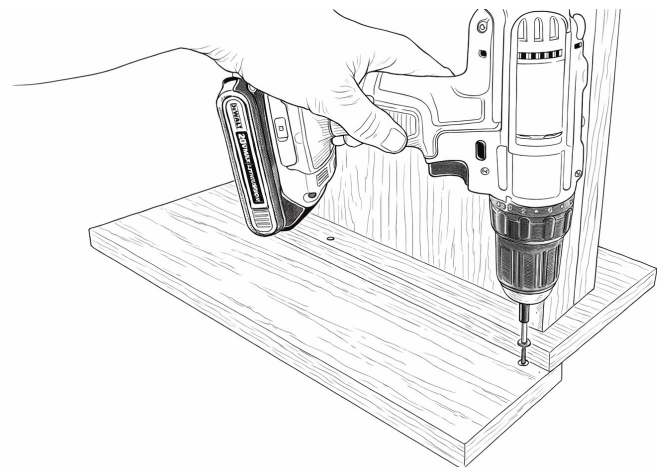

Step 4 Attach lip to Adjustable Table

Attach lip to adjustable table using three 1 1/4" screws. Tap in dowels to cover screw holes (use a small amount of glue).

Step 5 Attach Adjustable Table

Attach tilt plate to inner column first

Place adjustable table on flat surface with the hinge side up. Fasten the hinge to the adjustable column as shown. Use six 1/2 inch square head screws.

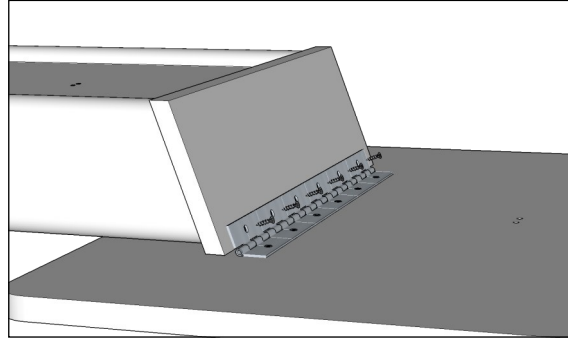

Step 6: Assemble Tilt Mechanism

Use two 2" Philips head screws to fasten the adjuster base to inner column.

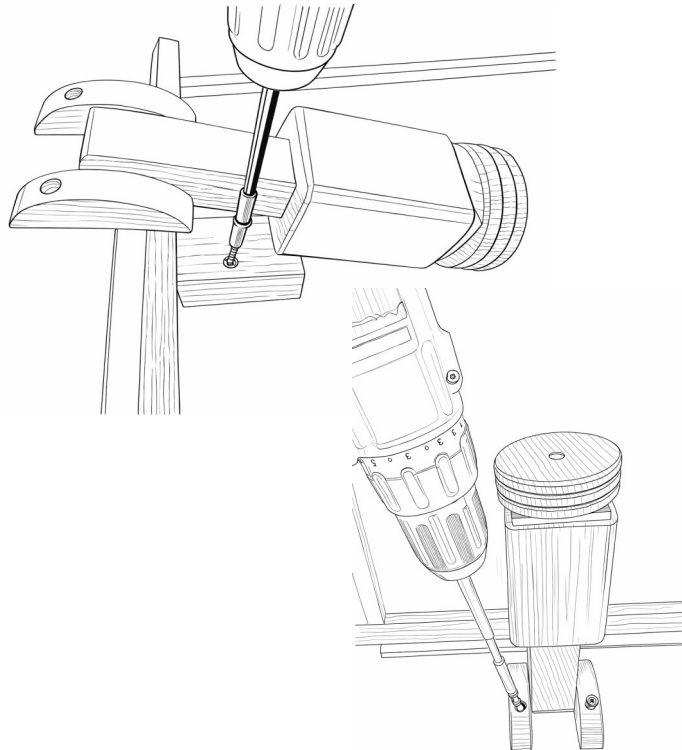

Attach to tilting table using original bores.

Reattach to tilt table

Step 7 Insert Gas Spring

Flip the adjustable column upside down. Insert the wider end of the gas spring into the place holder inside the adjustable column.

Step 8 : Final Assembly

Carefully insert the adjustable column into base. Be careful to avoid scratching the shelf with the end of the gas spring.

There's a tension knob that can be adjusted if the adjustable column moves too easily.

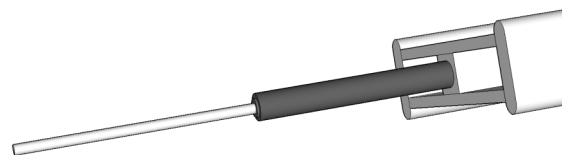

Troubleshooting:

1. The inner column keeps popping up and does not hold in place, or it's difficult to raise

Tighten the tension knob located on the back of the base column to keep stand from moving from it's position. Loosen if it seems to difficult to raise. Note: Do not lean on tilting table as the gas spring will not support the extra weight.

2. The tilt adjustment is different from what we're use to..

The old tilt adjustment was problematic with the bolt and set screw. The new tilt adjuster is much simpler and longer lasting. The part that will wear out is the adjuster arm that can be turned around to use the other side, or it can easily be replaced. To operate, loosen knob while holding the table with your other hand. Adjust angle and then tighten. Be sure to tighten securely so that the reading surface won't move.

3. Our furniture arrived with damage to the finish. There's a crack in the wood.

Great care was taken in packing your furniture, but occasionally it arrives damaged. Please take pictures of the damage and email them to sales@speakerstand.net. Some minor scratches can be covered up with a colored marker.

4. What do we do when the gas spring wears out?

The gas spring is guaranteed for one year. It can easily be replaced. Please contact us if the gas spring is not operating properly.

Maintenance:

We recommend cleaning your furniture with a product such as Orange-Glo, or a lemon oil, or Murphy's Oil Soap. Furniture polishes such as Pledge can dull the finish over time.